

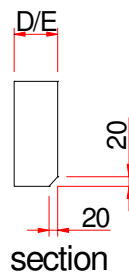

Heads

1.0

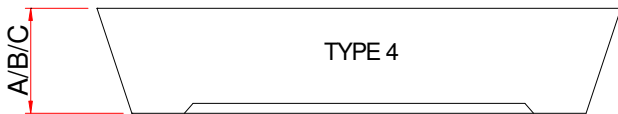
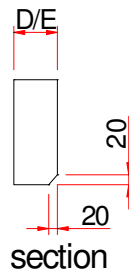
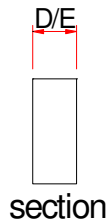
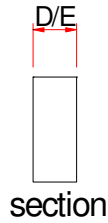

KEY

LINTEL HEIGHTS

- A = 140MM
- B = 215MM
- C = 290MM

LINTEL DEPTHS

- D = 100MM
- E = 120MM

140MM AND 150MM DEPTHS ALSO AVAILABLE

NOTE;

SPLAYED LINTELS INCORPORATE AN 80MM SPLAY TO EACH END

STRUCTURAL OPENING SIZES AVAILABLE INCLUDE:

- 488MM, 630MM, 915MM, 1200MM, 1770MM

NON-STANDARD LENGTHS MANUFACTURED TO ORDER

IMPORTANT NOTICE: SEMI-DRY CAST LINTELS ARE NON LOAD BEARING AND SHOULD BE USED IN CONJUNCTION WITH A SUITABLE STRUCTURAL LINTEL AS PER ENGINEER OR MANUFACTURERS RECOMMENDATIONS

TYPICAL WEIGHTS

- 140MM X 100MM - APPROX 30KG PER LM
- 215MM X 100MM - APPROX 46KG PER LM
- 290MM X 100MM - APPROX 69KG PER LM

- 140MM X 120MM - APPROX 36KG PER LM
- 215MM X 120MM - APPROX 55KG PER LM
- 290MM X 120MM - APPROX 75KG PER LM

UNITS CAN BE SUPPLIED WITH CAST IN LIFTING SOCKETS IF SPECIFIED

UNITS EXCEEDING SLENDERNESS RATIO WILL BE SUPPLIED SECTIONAL (PLEASE CONSULT SALES TEAM)

Heads